

RECYCLING UNITS
 BY CLEANRIVER RECYCLING
 SOLUTIONS
 MODEL: EXCEL SLANT TOP
 XS50-2
 BLUE/BLACK TWO STREAM
 TEL: 888-646-4246

GRAPHICS TO BE
 PROVIDED BY TOWN

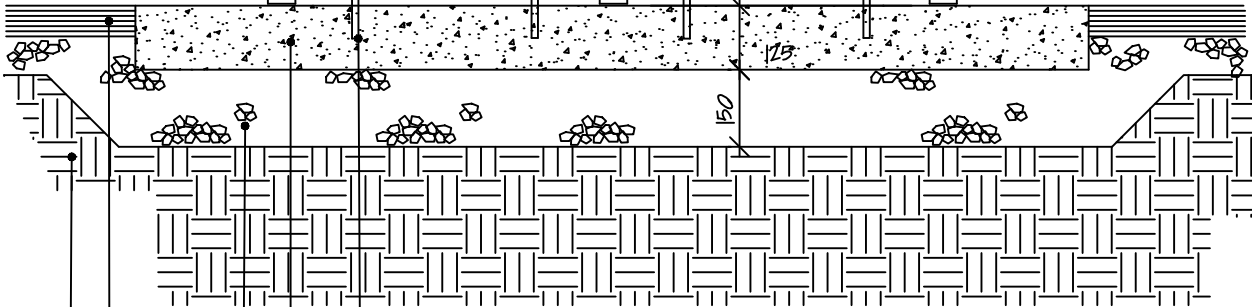

- 5.5"Ø X 4" SLEEVED ANCHOR BOLTS (x8). ALL FASTENERS TO BE HOT-DIPPED GALVANIZED
- 102MM THICK X 1524MM WIDE X 914.4 LONG CONCRETE PAD C/W PLATED INSERT FOR LIFTING
- 150MM X 150MM STEEL MESH
- 150mm DEPTH GRANULAR 'A' COMPACTED TO 95% S.P.D.
- REFER TO PLAN AND DETAILS FOR SURFACE TREATMENT
- COMPACTED SUBSOIL TO 95% S.P.D.



OPERATIONS SECTION

**WASTE RECEPTACLE - RECYCLING
 (RECYCLED PLASTIC)**

DWG. No.

AS-904

DATE

SEPT. 2020

REVISION No.